

- ① Without Brake and Soft Start
- ② With Brake Without Soft Start
- ③ With Brake and Soft Start

Characteristics

1. Light weight and good looking : The motor case is made by aluminum alloy with good thermal diffusivity and aesthetic out-looking.
2. Precision gear : The gear is made by steel alloy, with quench and grinding processed, moves quietly.
3. Buffer : The buffer can make the speed reducer operate without strong impact thus increase its service life.
4. IP54 motor : High starting torque, good thermal diffusivity, small size, low current, and high durability.
5. Electro-magnetic brake : The driving force of the direct type electro-magnetic brake can be easily adjusted.

Ordering example : SH-03LA1-220-M3x12T

Order no. : SH - 03 L A 1 - 220 - M3x12T

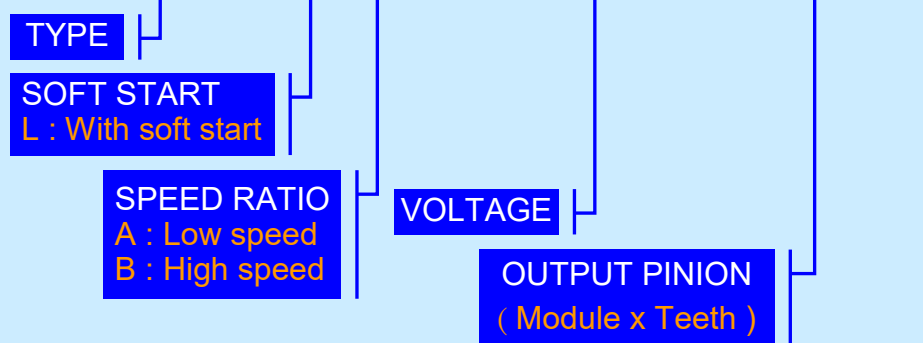

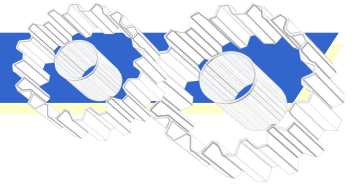

A SERIES

OUTPUT	
M3	12~15T
M3.5	10~13T
M4	10T

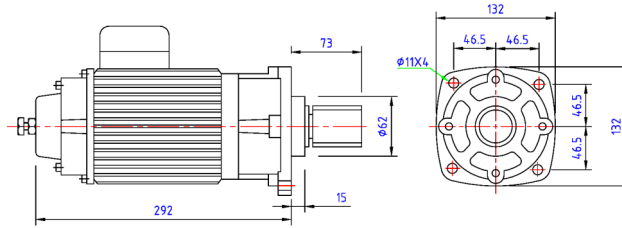

TYPE	POWER (Kw)	POLE (P)	RATIO	OUTPUT SPEED (Rpm)		MODULE	N.W. (Kg)
				50Hz	60Hz		
SH-03LA1	0.375	4	10	150	180	M3 M3.5 M4	15.5
SH-03LA2	0.25	6	10	100	120	M3 M3.5 M4	15.5
SH-03LA3	0.18	8	10	75	90	M3 M3.5 M4	15.5

B SERIES

OUTPUT	
M3	12~18T
M3.5	9~15T
M4	9~13T

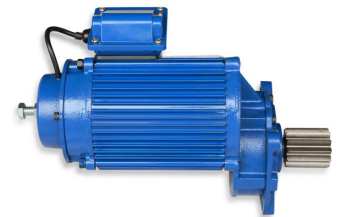
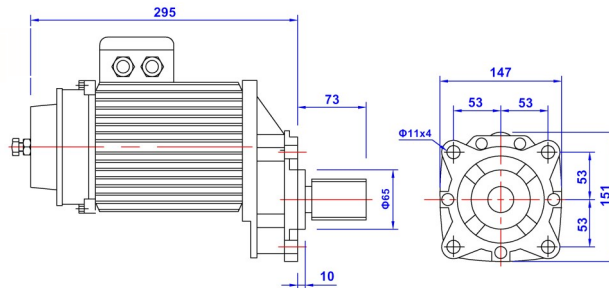

TYPE	POWER (Kw)	POLE (P)	RATIO	OUTPUT SPEED (Rpm)		MODULE	N.W. (Kg)
				50Hz	60Hz		
SH-05LA1	0.4	4	8.5	176	211	M3 M3.5 M4	21.5
SH-05LA2	0.3	6	8.5	118	141	M3 M3.5 M4	21.5
SH-05LA3	0.2	8	8.5	88	105	M3 M3.5 M4	21.5
SH-05LA4	0.4/0.13	4/12	8.5	176/59	211/70	M3 M3.5 M4	21.5
SH-05LA5	0.2/0.07	4/12	8.5	176/59	211/70	M3 M3.5 M4	21.5

D SERIES

OUTPUT	
M3.5	20~28T
M4	17~27T
M5	14~19T

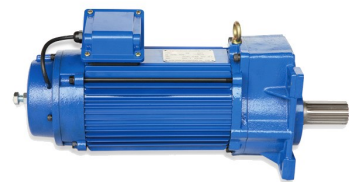
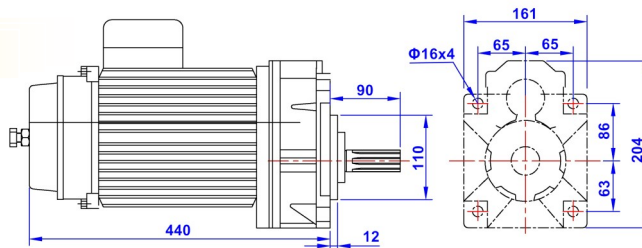

TYPE	POWER (Kw)	POLE (P)	RATIO	OUTPUT SPEED (Rpm)		MODULE	N.W. (Kg)
				50Hz	60Hz		
SH-10LA1	0.75	4	13	113	135	M3.5 M4 M5	22
SH-10LA2	0.6	6	13	75	90	M3.5 M4 M5	22
SH-10LA3	0.4/0.13	4/12	13	113/38	135/45	M3.5 M4 M5	27
SH-10LA4	0.6/0.2	4/12	13	113/38	135/45	M3.5 M4 M5	29
SH-15LB1	1.1	4	13	113	135	M4 M5 M6	36
SH-15LB2	0.75	6	13	75	90	M4 M5 M6	36
SH-15LB3	0.75/0.25	4/12	13	113/38	135/45	M4 M5 M6	32
SH-20LB1	1.5	4	13	113	135	M4 M5 M6	40
SH-20LB1A	1.5	4	16.5	88	106	M4 M5 M6	40
SH-20LB2	1.1	6	13	75	90	M4 M5 M6	40
SH-20LB3	1.1/0.37	4/12	13	113/38	135/45	M4 M5 M6	36
SH-20LB4	1.5/0.5	4/12	13	113/38	135/45	M4 M5 M6	36

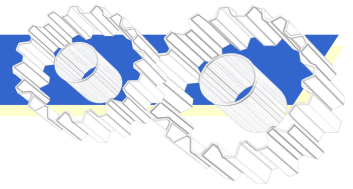

E SERIES

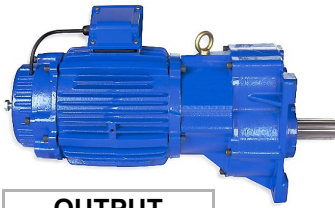

OUTPUT	
M4	17~27T
M5	14~19T
M6	11~15T

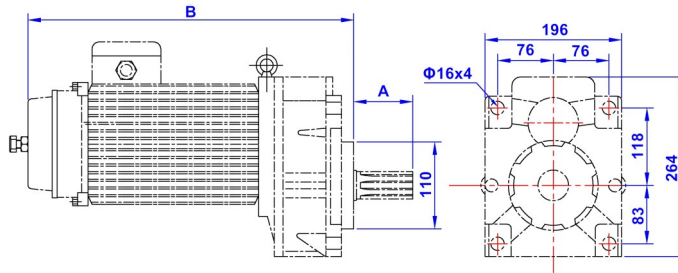

MODEL-E	A	B
SH-20LA	91	478
SH-30LA	91	484
SH-50LB1	98	501
SH-50LA2	98	501
SH-50LA3	98	501
SH-50LA4	98	501

TYPE	POWER (Kw)	POLE (P)	RATIO	OUTPUT SPEED (Rpm)		MODULE	N.W. (Kg)
				50Hz	60Hz		
SH-20LA1	1.5	4	16	91	109	M4 M5 M6	50
SH-20LA2	1.1	6	16	61	73	M4 M5 M6	50
SH-20LA3	0.75/0.25	4/12	16	91/30	109/36	M4 M5 M6	50
SH-30LA1	2.2	4	16	91	109	M4 M5 M6	65
SH-30LA2	1.5	6	16	61	73	M4 M5 M6	65
SH-30LA3	1.5/0.5	4/12	16	91/30	109/36	M4 M5 M6	65
SH-50LB1	3	4	16	91	109	M4 M5 M6	88
SH-50LA2	2.2	6	16	61	73	M4 M5 M6	88
SH-50LA3	2.2/0.75	4/12	16	91/30	109/36	M4 M5 M6	90

F SERIES



OUTPUT	
M4	16~25T
M5	13~20T
M6	13~16T

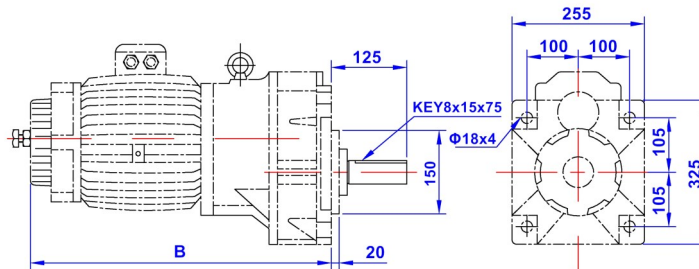

MODEL-F	B
SH-50LA1	570
SH-75LA	590
SH-1HLA	610

TYPE	POWER (Kw)	POLE (P)	RATIO	OUTPUT SPEED (Rpm)		MODULE	N.W. (Kg)
				50Hz	60Hz		
SH-50LA1	3.75	4	18.5	79	95	M4 M5 M6	110
SH-50LA2	2.2	6	18.5	53	63	M4 M5 M6	110
SH-50LA3	2.2/0.75	4/12	18.5	79/26	95/32	M4 M5 M6	110
SH-75LA1	5.5	4	18.5	79	95	M4 M5 M6	139
SH-75LA2	3.75	6	18.5	53	63	M4 M5 M6	139
SH-75LA3	3/1	4/12	18.5	79/26	95/32	M4 M5 M6	139
SH-75LA4	3.75/1.25	4/12	18.5	79/26	95/32	M4 M5 M6	148
SH-1HLA1	7.5	4	18.5	79	95	M4 M5 M6	148
SH-1HLA2	5.5	6	18.5	53	63	M4 M5 M6	148
SH-1HLA3	5.5/1.8	4/12	18.5	79/26	95/32	M4 M5 M6	153
SH-1HLA4	7.5/2.5	4/12	18.5	79/26	95/32	M4 M5 M6	178